

# MCU接口固定8Bit

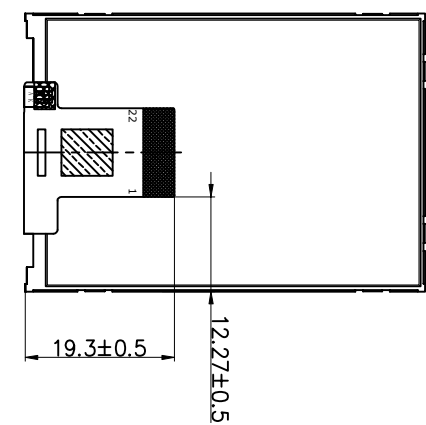

PIN	SYMBOL
1	LED A
2	LED K
3	SDA/NC
4	SMD/NC
5	I0CC/1.8V/2.8V
6	VCC/2.8V
7	DB07
8	DB06
9	DB05
10	DB04
11	DB03
12	DB02
13	DB01
14	DB00
15	RD
16	WR/NC
17	RS/CLK
18	CS
19	TE
20	RESET
21	GND
22	GND

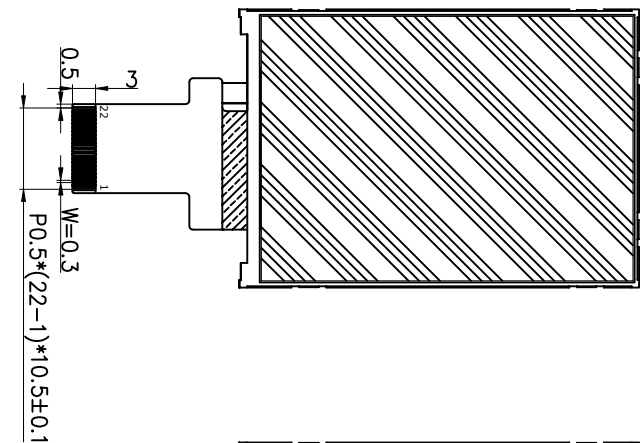
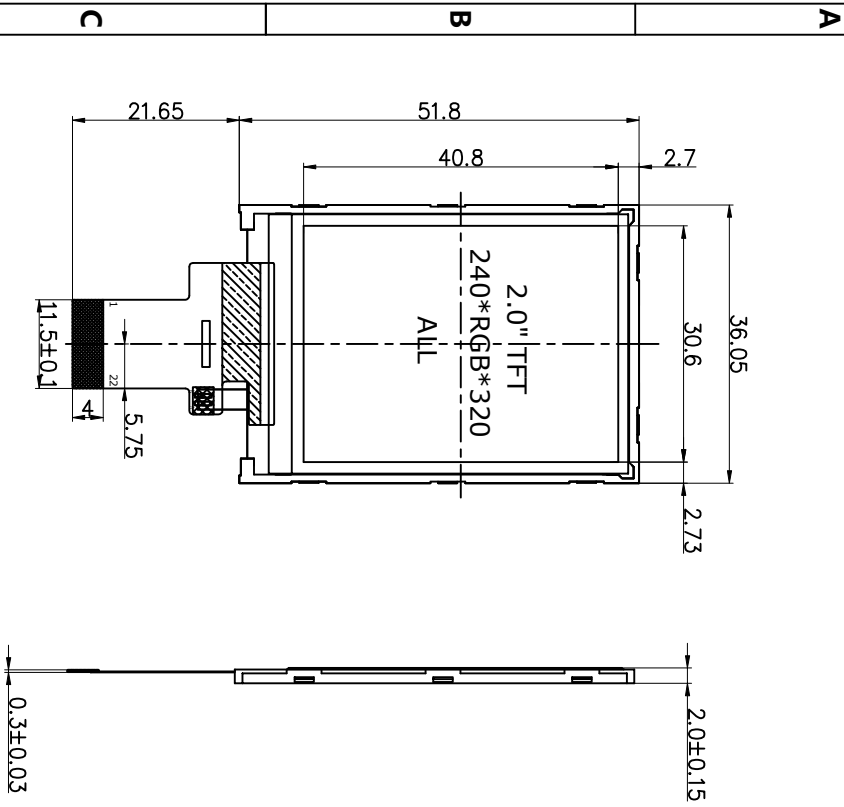
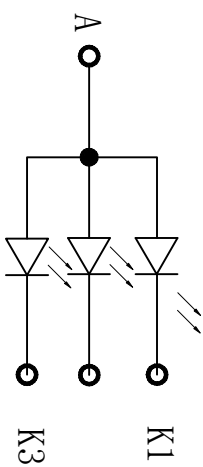

## LED CIRCUIT DIAGRAM

### NOTES:

1. DISPLAY MODE: 2.0" IPS TFT LCD, Transmissive
2. DRIVER IC: ST7789V
3. VIEWING DIRECTION: ALL
4. BACKLIGHT: 3 CHIP-WHITE LED, IF=60mA, VF=3.2V  
BRIGHTNESS=300 CD/M2.
5. OPERATING TEMPERATURE: -20°C TO 70°C  
STORAGE TEMPERATURE: -30°C TO 80°C
6. GENERAL TOLERANCE: ±0.20

TOLERANCE	SCALE	N.T.S
.X	±	mm
.XX	±	mm
	± 1°	

**HONSEAN** SHENZHEN HONSEAN SMART DISPLAY TECHNOLOGY CO.,LTD

深圳市弘盛智能显示科技有限公司

DRG DATE	MODEL:
DRG BY Welly	TITLE:
APPROVED Jan	P/N
	VER. 01

Page 1 Of 1